

Q100

Roll Formed
Roller Shutter

FEATURES

SECURE

ROBUST

EASILY
INSTALLED

PASSES
AUSTRALIAN
STANDARDS

CYCLONE
RATED TO
COMPLY WITH
AS/NZS
1170.2-2011

UNIQUE FEATURES



• Guide with
Silencing Strip



• Safety System



• 100mm Slat



Q100 - Roll Formed Roller Shutter

Q100 Roll Formed Roller Shutter with 100mm Galvanized Steel material as Manufactured by ARCO (Qld).

The Heavy Duty steel slat is designed to withstand the wear and tear of industrial and commercial applications with minimal maintenance. The rolled slat can be replaced individually should the damage occur.

ARCO (Qld) Steel Roller Shutters are purposely built with Guide Channel that has Nylon Rubber to minimize the noise that comes from the interlocking slats. Q100 Steel Roller Shutters can be Hand operated or Electric operated. Each slat is fitted with nylon end clips to reduce the lateral movements and ensure smooth operation for the life of the door.

Our Product Range

Quality in every product



A3000
Foldaway



A5000
Vertical Lift



STADIUM
Roller Grille



A1000
Tilt Up Door



A1500
Fully Recessed Door



A2000
Hingeway Door



ARCADE 3
Roller Grille



MIKADO
Folding Door



SLIMLINE
Roller Shutter



CASINO
Aluminium Roller Grille



CLEAR ROLLER
Roller Shutter



Q 100
Steel Roller Shutter

Guaranteed service and quality with ARCO (Qld)

Features and Benefits

Recommended Specification

Q 100 Roll Formed Roller Shutter with 100mm Galvanized Steel materials as manufactured by ARCO (Qld).

Design Features

The Heavy Duty steel slat is designed to withstand the wear and tear of industrial and commercial applications with minimal maintenance. The rolled slat can be replaced individually should damage occur.

ARCO (Qld) Q100 Steel Roller Shutters has a purposely built Guide Channel that has Nylon Rubber to minimize the noise that comes from the interlocking slats. Q100 Steel Roller Shutters can be Hand Operated or Electric Operated. Each slat is fitted with nylon end clips to reduce the lateral movements and to ensure smooth operation for the life of the door.

For Cyclonic conditions, high strength wind locks and guides are designed to prevent the curtain from blowing out of the guide rail. Wind locks can be every 2nd or every 4th slat depending on the location and function.

Standard Curtain

The Series Q100 are available in 0.8mm and 1mm thickness.

Note: Recommended maximum width is 10 metres. Refer to ARCO (Qld) Counterweight products for larger single span openings.

Curtain Alternatives

SLOTTED Slats (Ventilation) – Any number of the slats can be punched with 90mm wide x 25mm high slot. **MULTI HOLE Slats** – The slats can also be continuously perforated with 2.41mm diameter holes at 3.66mm staggered centres prior to rolling (this allows maximum air flow the holes are over the entire surface area of the slat). These perforations cover 40% of the slat surface.

Roller Drum

The roller drum is a robust seamless steel tube encasing the shaft and helical counterbalance spring (for manually

operated). The end caps and roller bearings are designed to give smooth operations.

Guide Channels

2mm galvanized steel is roll formed with the nylon rubber to make a noticeably quiet steel Roller Shutter when opens and closes on a 100mm x 48mm guide channel.

Support Bracket

The support brackets are fabricated from mild steel plate and designed to be fitted to a solid fixing point of adequate strength to support the weight of the door and any wind loading that may be required (adequate fixing points to be supplied by others).

Bottom Rail

The Bottom Rail is roll formed from 3mm galvanized steel to make a 50mm x 50mm angle. This angle is securely fixed to the front of the slat (bottom of angle protrude to inside of opening). This can also be Aluminium Bottom Rail.

Operation

Hand Operation – Small Roller Shutters with an area of 6 square meters maybe hand operated. Pull hook is provided for opening and closing the door.

Electric Operated – Motorization includes 1Hp motor incorporating a standard reversing contractor and an Up, Down, Stop button controller with a hand chain override in case of power failure. For Remote Control and other options, please contact ARCO (Qld). All wirings will be by others.

Locking Operation

Hand Operated – will have Sliding Shoot bolts.

Electric Operated – will be secured by electrical motors and controls.

Finish

Standard finish is Galvanised Curtain and Guides with all other exposed parts prime painted. Optional finishes to Slats only is powder coating.

Q100 Specifications

Bundle Diameter and Minimum Required Headroom

Height	Width	≤ 7000		8000		11000		12000	
2000		330	600	330	600	360	730	400	750
3000		380	625	380	625	440	770	440	770
4000		420	645	450	660	470	785	510	805
5000		460	665	480	675	510	805	540	820

Nib Clearances	
Guide	150
Head	285

Bundle Diameter and Minimum Required Headroom

Height	Width	≤ 7000		8000		11000		12000	
6000		490	680	510	690	570	835	570	835
7000		530	700	550	710	600	850	600	850
8000		560	715	580	725	620	860	-	-
9000		590	730	630	750	650	875	-	-

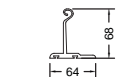

ALUMINIUM BOTTOM RAIL (Up to 5800mm Only)

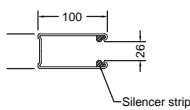

STANDARD 100mm GUIDE CHANNEL

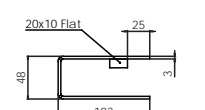

WIND LOCKED (100mm) GUIDE CHANNEL

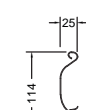

100mm SLAT

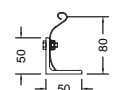

STEEL ANGLE BOTTOM RAIL

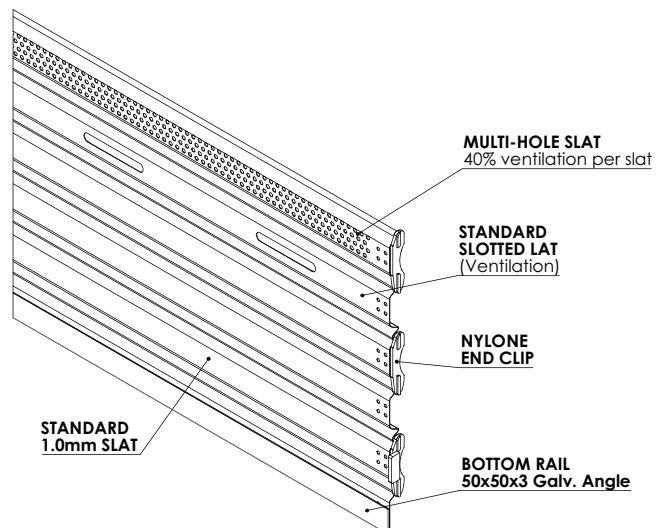

ARCO (QLD) has a continuous program of product development and reserves the right to change specifications at any time without notice.

ARCO (QLD) Pty. Ltd. ABN 27 108 275 896

334 Christensen Road South, Stapylton, QLD 4207 | Tel: 61-7 3807 5364 | Fax: 61-7 3382 7929
web: www.arcoqld.com.au